

T-SLOT MILLING CUTTERS

ETC90

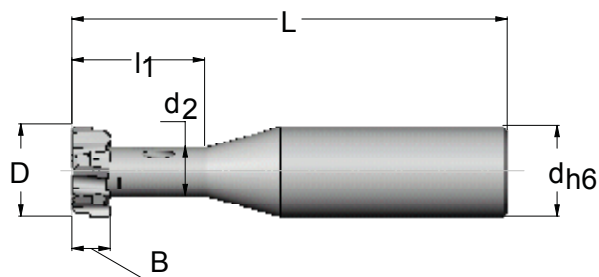

T-slot milling cutters with highly precise indexable insert system
 Optimal power transmission through cross and/or star drive keys
 Extreme stability for long tool lives



ETC90 Smooth shank tool holders								INS
Article	D	d ₂	d _{h6}	L	l ₁	lc	kg	
20G.20.1112.01	20	11	20	96	30	yes	0.18	ECT2008.R
20G.20.1313.01	24	13	20	100	35	yes	0.20	ECT2410.R
20G.25.1713.01	31	17	25	105	40	yes	0.37	ECT3113.R

Bigger diameters ET90 page 94

Data Interchangeable heads ECT				
Article	D	Z _{eff}	B	Weight in g
EC.T2008.32.01 SKY77	20	3	8.5	25.1
EC.T2410.33.01 SKY77	24	3	10	41.2
EC.T3113.33.01 SKY77	31	3	13	98.4

INTERCHANGEABLE HEADS **EC**

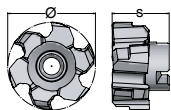

ECT

AS	Ø			s		
3	20	24	31	08	10	13
	20	24	31	13	15	18

Matching of machining parameters
with the AV material groups

				Steel						
Article		Designation		A22	A21	A20	A19	A18	A17	A16
ECT2008...	EC.T2008.32.01 SKY77	ECT 200808 TR-25	h_{max}	0.11	0.1	0.1	0.08	0.05	-	-
			v_c	180-210	180-210	160-190	150-180	120-160	-	-
ECT2410...	EC.T2410.33.01 SKY77	ECT 241010 TR-25	h_{max}	0.11	0.1	0.1	0.08	0.05	-	-
			v_c	180-210	180-210	160-190	150-180	120-160	-	-
ECT3113...	EC.T3113.33.01 SKY77	ECT 311312 TR-25	h_{max}	0.11	0.1	0.1	0.08	0.05	-	-
			v_c	180-210	180-210	160-190	150-180	120-160	-	-

				Cast iron					
Article		Designation		D21	D20	D19	D18	D17	D16
ECT2008...	EC.T2008.32.01 SKY77	ECT 200808 TR-25	h_{max}	0.1	0.08	0.07	0.05	-	-
			v_c	180-240	170-230	150-200	140-170	-	-
ECT2410...	EC.T2410.33.01 SKY77	ECT 241010 TR-25	h_{max}	0.1	0.08	0.07	0.05	-	-
			v_c	180-240	170-230	150-200	140-170	-	-
ECT3113...	EC.T3113.33.01 SKY77	ECT 311312 TR-25	h_{max}	0.1	0.08	0.07	0.05	-	-
			v_c	180-240	170-230	150-200	140-170	-	-

INS



ECT2008...	08B.3514.7991	TX215
ECT2410...	08B.0520.7991	TX220
ECT3113...	08B.0520.7991	TX220