

# T-SLOT MILLING CUTTERS

## ETC90

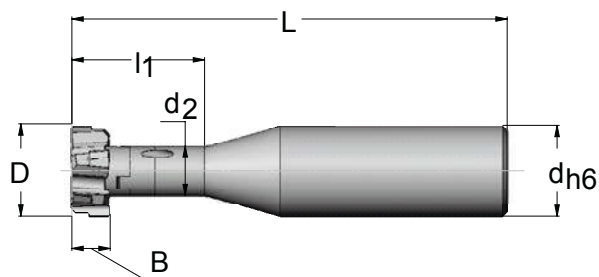

T-slot milling cutters with highly precise indexable insert system  
 Optimal power transmission through cross and/or star drive keys  
 Extreme stability for long tool lives



ETC90 Smooth shank tool holders								INS
Article	D	d <sub>2</sub>	d <sub>h6</sub>	L	l <sub>1</sub>	lc	kg	
20G.20.1112.01	20	11	20	96	30	yes	0.18	ECT2008.R
20G.20.1313.01	24	13	20	100	35	yes	0.20	ECT2410.R
20G.25.1713.01	31	17	25	105	40	yes	0.37	ECT3113.R

larger diameters ET90 page 98

Data Interchangeable heads ECT				
Article	D	Z <sub>eff</sub>	B	Weight in g
EC.T2008.32.01 SKY77	20	3	8.5	25.1
EC.T2410.33.01 SKY77	24	3	10	41.2
EC.T3113.33.01 SKY77	31	3	13	98.4

# INTERCHANGEABLE HEADS **EC**

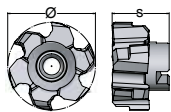

ECT							
AS	Ø			s			
3	20	24	31	08	10	13	
	20	24	31	13	15	18	

Matching of machining parameters  
with the AV material groups

				Steel						
	Article	Designation		A22	A21	A20	A19	A18	A17	A16
ECT2008...	EC.T2008.32.01 SKY77	ECT 200808 TR-25	$h_{max}$	0.11	0.1	0.1	0.08	0.05	-	-
			$v_c$	180-210	180-210	160-190	150-180	120-160	-	-
ECT2410...	EC.T2410.33.01 SKY77	ECT 241010 TR-25	$h_{max}$	0.11	0.1	0.1	0.08	0.05	-	-
			$v_c$	180-210	180-210	160-190	150-180	120-160	-	-
ECT3113...	EC.T3113.33.01 SKY77	ECT 311312 TR-25	$h_{max}$	0.11	0.1	0.1	0.08	0.05	-	-
			$v_c$	180-210	180-210	160-190	150-180	120-160	-	-

				Cast iron					
	Article	Designation		D21	D20	D19	D18	D17	D16
ECT2008...	EC.T2008.32.01 SKY77	ECT 200808 TR-25	$h_{max}$	0.1	0.08	0.07	0.05	-	-
			$v_c$	180-240	170-230	150-200	140-170	-	-
ECT2410...	EC.T2410.33.01 SKY77	ECT 241010 TR-25	$h_{max}$	0.1	0.08	0.07	0.05	-	-
			$v_c$	180-240	170-230	150-200	140-170	-	-
ECT3113...	EC.T3113.33.01 SKY77	ECT 311312 TR-25	$h_{max}$	0.1	0.08	0.07	0.05	-	-
			$v_c$	180-240	170-230	150-200	140-170	-	-

INS		
ECT2008...	08B.3514.7991	TX215
ECT2410...	08B.0520.7991	TX220
ECT3113...	08B.0520.7991	TX220